



User Manual (7.1 version)

Rev. 05/19



Android Network Digital Signage

Operating Instructions for Digital Signage

Technical Specifications

	ITEM		
Panel	LCD size	21.5"	
	Light source	WLED	
	Resolution	1920*1080 (pixels)	
	Brightness (typ.)/(min)	500cd /m ²	
	Contrast (typ.)	3000:1	
	Response (ms)	18ms	
	Pixel pitch	0.24825x0.24825mm	
	Refresh rate	60Hz	
	Viewing angle	89°/89°/89°/89°	
	Color saturation	68%	
	Viewable area	476.64x268.11mm	
	Chromaticness	16.7M	
Power supply	Voltage	AC100-240V	
	Power Consumption	60W	
Environment	Operating temperature	32~104 °F (0~40 °C)	
	Storage temperature	-4~140 °F (-20~60 °C)	
	Storage humidity	10~90% RH Non-condensing	
	Operating humidity	10~90% RH Non-condensing	
Functions	Operating system	Android 7.1	
	Processor	Quad-core ARM Cortex-A17, 1.8GHz	
	RAM	2G	
	Built-in memory	8G	
	Decoding resolution	1080P FHD compatible	
	Playback mode	Yes	
	Touch support	Yes	

Functions	Supported Video Files	RMVB, FLV, MPEG1/2/4, AVI, DIVX, XDIV, WMV9, H.264, VC-1, MOV, MKV, MP4, TS, M2T	
	Supported Photo Files	BMP/PNG/GIF/JPEG	
	Supported Audio files	MP3, WMA, WAV, AAC+, MP2 dec, Vorbis (Ogg), AC3, FLAC, APE, BSAC;	
	RTC (real-time clock)	Yes	
	Schedule power on/off	Yes	
	System update	Yes	
	App installation	Support download and installation	
	I/O interfaces	USB 2.0	X2
		HDMI (Output)	X1
SD		X1	
Rj45		X1	
3G SIM (Optional)		X1	
Structure	Net weight	18kg (Screen)/10Kg (stand)	
	Gross weight	22kg (Screen)/30Kg (stand)	
	Unit dimensions	618.6x70x290.9mm/450x350x1018(stand)mm	
	Package dimensions	800x320x530mm/1100x490x630(stand)mm	
	Shell material	Metal	
	Shell color	White	
Language	OSD	English, French, German, Simplified Chinese ect.	

Parts and Connection

Packing List

Wall Mounting

Name	
1x Power Cord	●
3x Keys	●
1x 6mm Allen Wrench	●
1x User Manual	●
1x Warranty card, certification	●
2x M4x30 screw	●

Floor Standing

Name	
1x Power Cord	●
4x Keys 6x M8x25 screw	●
1x 6mm Allen Wrench	●
1x User Manual	●
1x Warranty card, certification	●
4x Foot pad	●

Steps for Assembly (2 people are required)

1. Screw the wall bracket onto the back of the machine

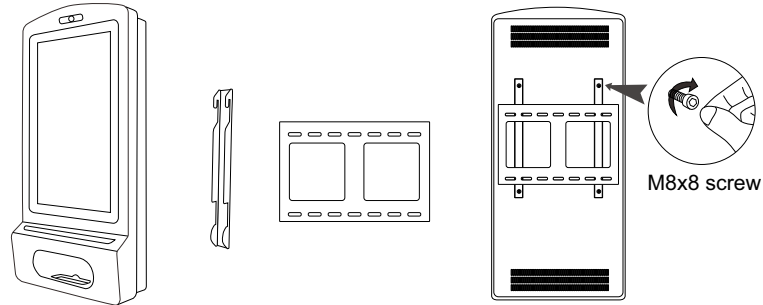

2. Use screws to secure the frame and fuselage of the machine

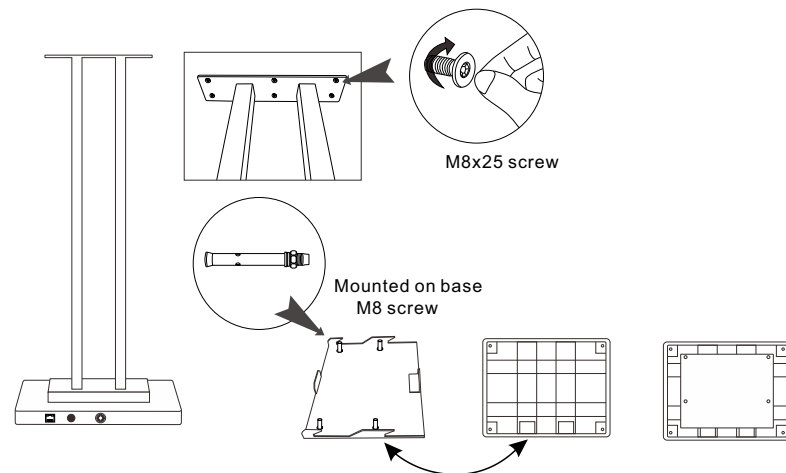

3. Screw the machine holder on the bottom

Directions for use

How to add hand sanitizer



① Open the machine



② Container for hand sanitizer



④ Types of hand sanitizer
(liquid / alcohol / gel)



③ open the cover

Light signals



Sufficient (Green)



Empty (Red)

The sensor



①

The border color shows blue when not in use

②

The color of the border shows green when reaching in (3 seconds for missing handsanitizer)

③

Wash your hands outside after dropping the liquid soap. The border color is blue

How to replace the correct dispense head

Change the Liquid to Gel



Unscrew the dispense head for Liquid and take it off



Take the dispense head for Gel and screw it

Change the Gel to Liquid



Unscrew the dispense head for Gel and take it off



Take the dispense head for Liquid and screw it

Remote Control



1. Power on/off button.



2. Press this button to return to home screen.



3. Press MENU to organize screens and apps.



4. Mute. Press this button to mute the sound.



5. Upwards Arrow. Move up selection or move the cursor up.



6. Downwards Arrow. Move down selection or move the cursor down.



7. Leftwards Arrow. Move selection to the left or move the cursor left.



8. Rightwards Arrow. Move selection to the right or move the cursor right.



9. Confirm button, select the use menu or setup menu, press this button to confirm



10. Turn volume up



11. Turn volume down.



12. Return to previous page or a level up in an app.

NOTE: Only buttons shown above have functions.

Description of Basic Operation

Power on/Standby

Insert the power plug into the outlet. If the Digital Signage has the switch button "I", turn it on.
In power on state, press the "⏻" button on the remote control, and the Digital Signage enters standby state.

Interface and Home Screen

After power on, the machine will launch home screen, as shown below:



will launch home screen, as



Description of Wallpaper Switch

We suggest using a mouse to change the wallpaper.
Connect a mouse with the digital panel through USB port, then follow the steps below:

- 1.click "Setting"
- 2.At the setting menu, click "Display"
- 3.At the Display setting menu, click "Wallpaper", then choose a folder.
- 4.Then select an image you would like to set up as background.
- 5.Confirm the selection by clicking "Set wallpaper".

File Manager

- 1.Click the Main Apps button "⋮" in the Home screen to enter the "APPS" menu interface (Fig. 2);
- 2.Click the "Explorer" icon in the "APPS" menu interface (Fig. 2) and enter "Explorer" menu (Fig. 3);
- 3.Choose storage in the "Explorer" menu to read the files from different devices.



Fig. 1

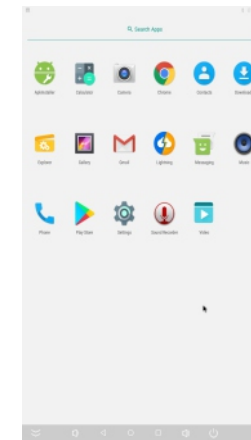

Fig.2



Fig.3

Local Settings

- 1.Click the "Settings" icon (Fig. 1) and enter "Settings" menu (Fig. 2);
- 2.Click "Wi-Fi" and choose options then set up the WIFI connection.

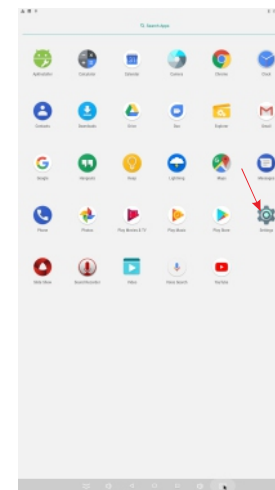

Fig. 1

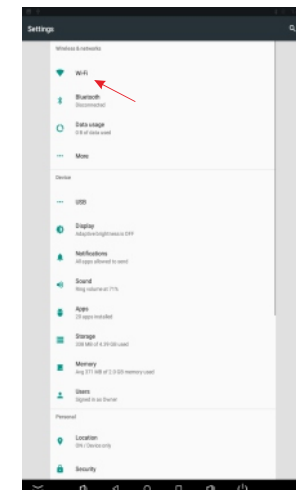
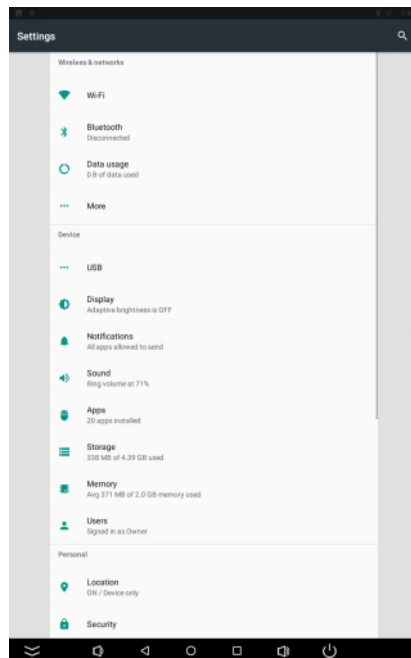

Fig.2

Description of Settings Interface (shown on the right)

Icon	Function
	WiFi switch
	Data usage
	Bluetooth
	USB
	Sound & notification
	Battery saver
	HDMI
	Display
	Storage
	Apps
	Screenshot Setting
	Location
	Accounts
	Backup & reset
	Security
	Language & input
	Date & time
	Printing
	Accessibility
	About device



Status of Menu Bar

1. Click the setting
2. At the setting menu click the display menu
3. At the display setting menu unselect the display navigation check box

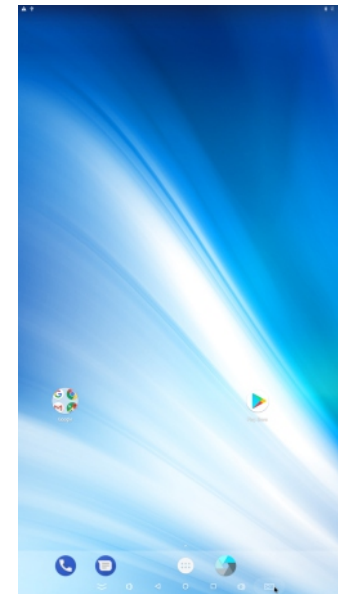

Fig. 1

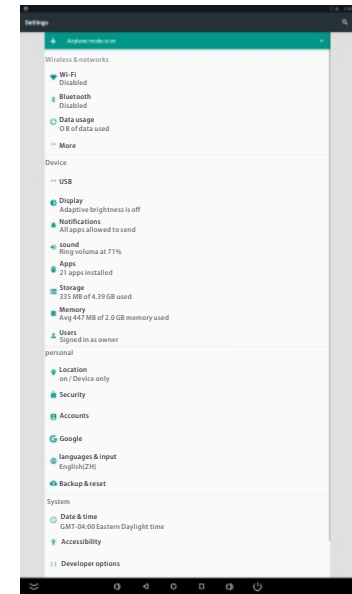

Fig. 2

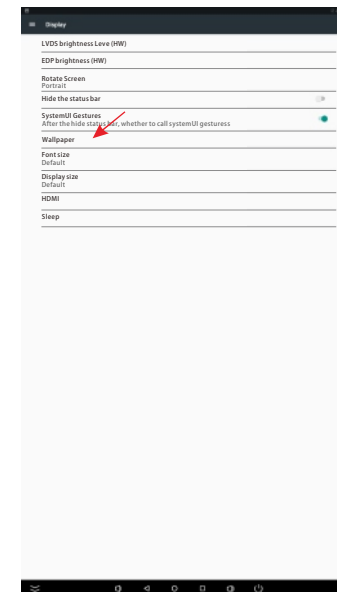

Fig. 3